

vonMises stresses on one of the inner barrel-yoke plates, red color >150_MPa

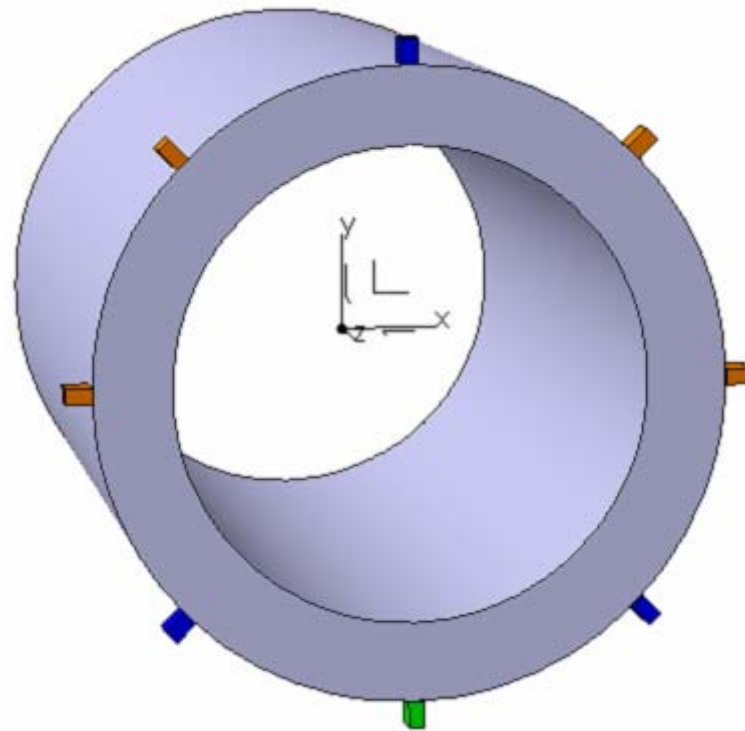

Points for axial load bearings

blue color: rigid joints

green: soft spring pre-loaded with 20% of nominal axial load

orange: soft springs pre-loaded with 10% of nominal axial load

Discrepancy axial force

TDR, chapter 2.4.3.3:

20 tons

"Draft Magnet Interface Document 0.8, rev 749", chapter C.4.5.1:

The magnetic forces at the project current must be considered as follows:

- a) an axial force of 60 t in upward direction plus the force due to a misalignment of 2 cm w.r.t. the nominal position, in each direction;
- b) a radial force of 10 t, at the project current, or the force due to a misalignment of 2 cm w.r.t. the nominal position, in each direction.